

THE ARANDA

This spacious one story design features a welcoming covered entry which leads to an elegant foyer and a spacious great room. Highlights of the great room include a double coffered ceiling and sliding glass doors that open to the covered lanai.

The well-appointed kitchen boasts a separate pantry and a raised snack bar that overlooks a sunlit breakfast area and the great room.

The master bedroom suite has a view of the covered lanai and features a beautiful coffered ceiling, large walk-in closet and sumptuous master bath complete with his-and-her vanities, Roman tub, separate shower, and private water closet.

This split plan home is further enhanced by two additional bedrooms, study with double-door entry, cabana bath, separate laundry room, and two-car courtyard garage.

Air Conditioned Living Area	2456 sq. ft.
Covered Lanai	329 sq. ft.
Covered Entry	61 sq. ft.
Garage	477 sq. ft.
Total	3323 sq. ft.

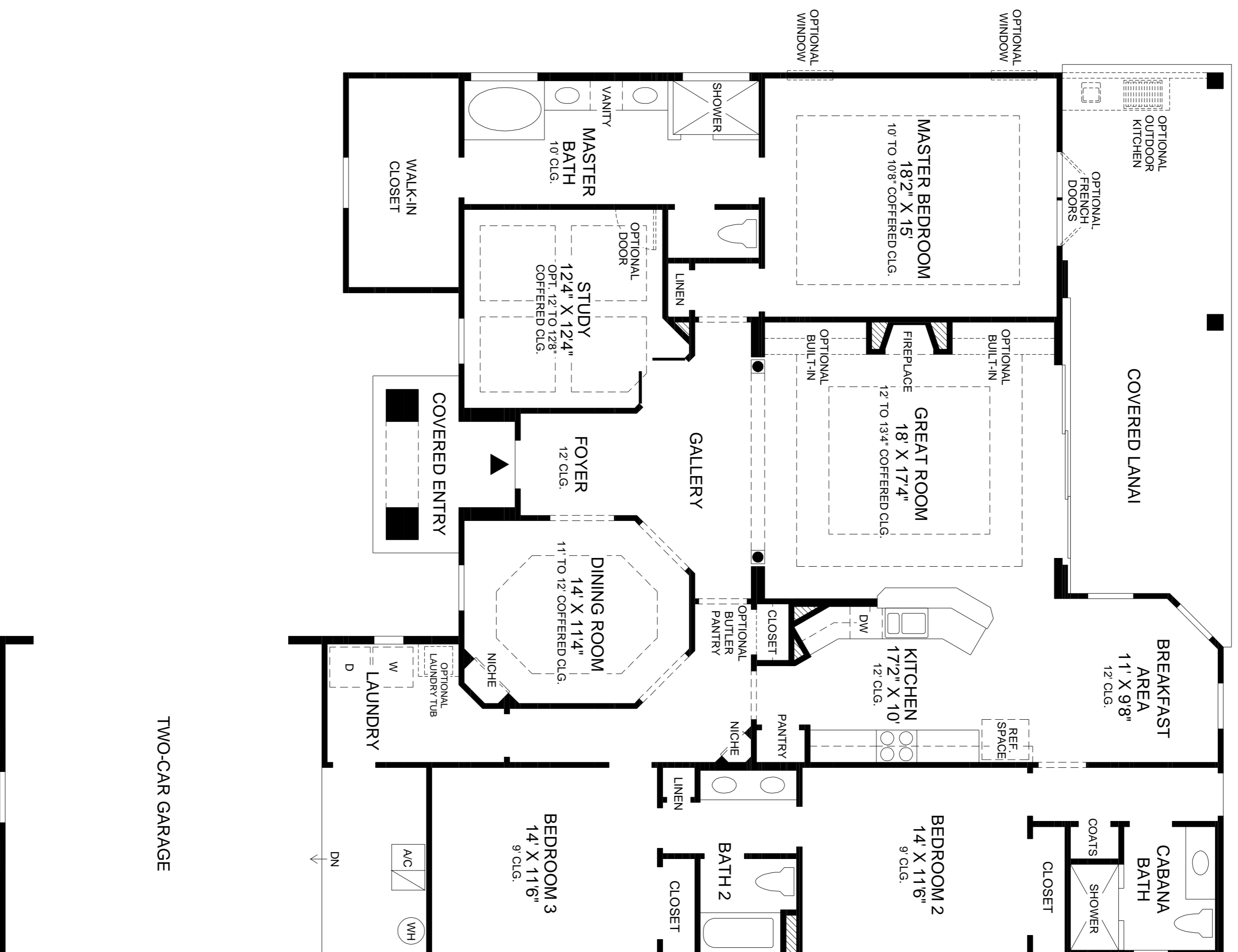

FLOOR PLAN

All dimensions are approximate, shown to the maximum dimensions of each room, and are subject to field variation. Dimensions should not be used to calculate room square footage. Some windows, exterior features, ceiling heights, and floor plans may vary with elevations. Features may also vary from community to community. Please consult a Sales Manager for details. Options purchased must be specified in exhibit B.

(FL_MASTER)_0524 © 2006 TOLL BROTHERS, INC. (ARNA)

Toll Brothers
America's Luxury Home Builder™
tollbrothers.com

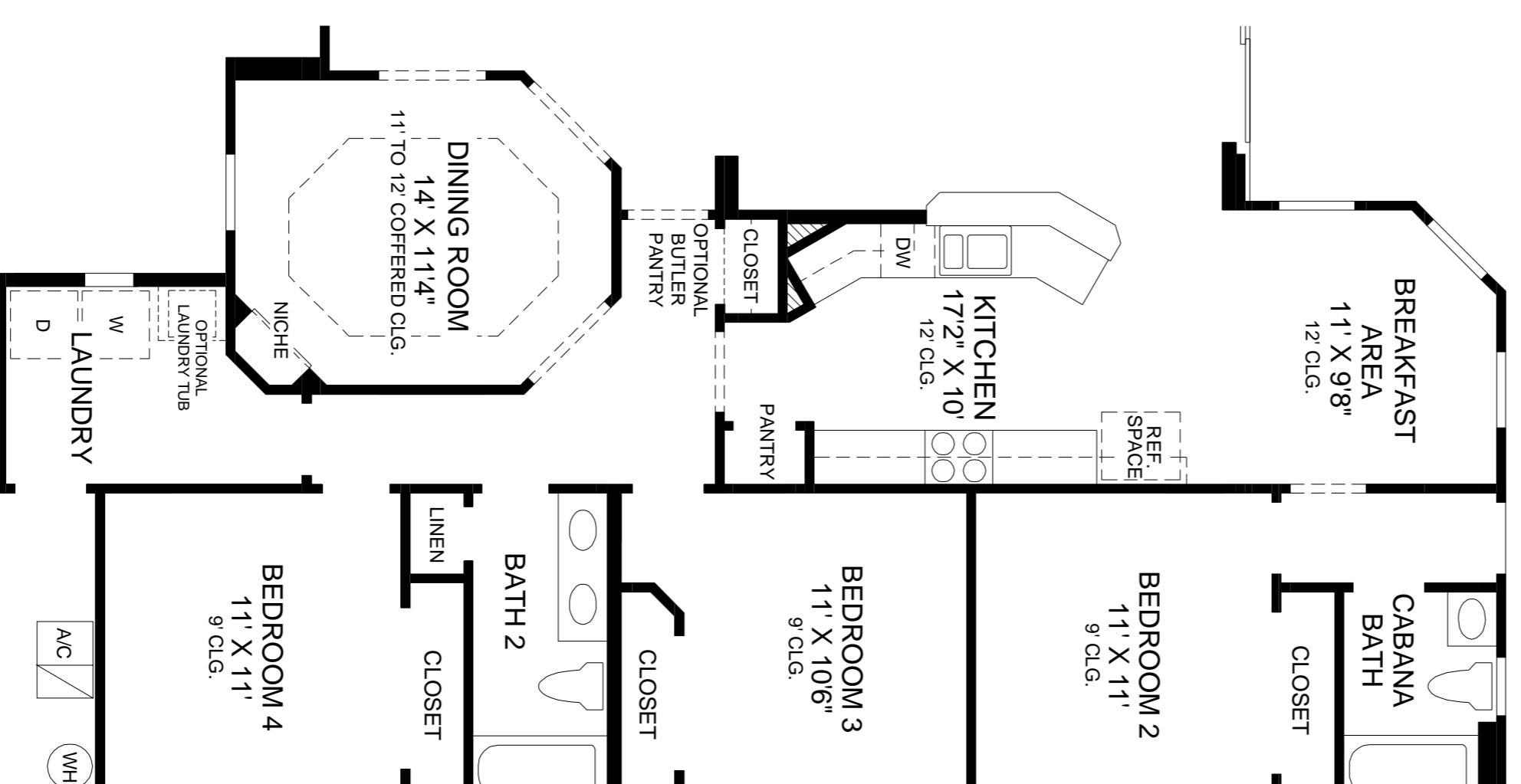

NOTE: THIS OPTION FEATURES AN ADDITIONAL 94 SQ. FT. OF AIR CONDITIONED LIVING AREA.

OPTIONAL FOURTH BEDROOM

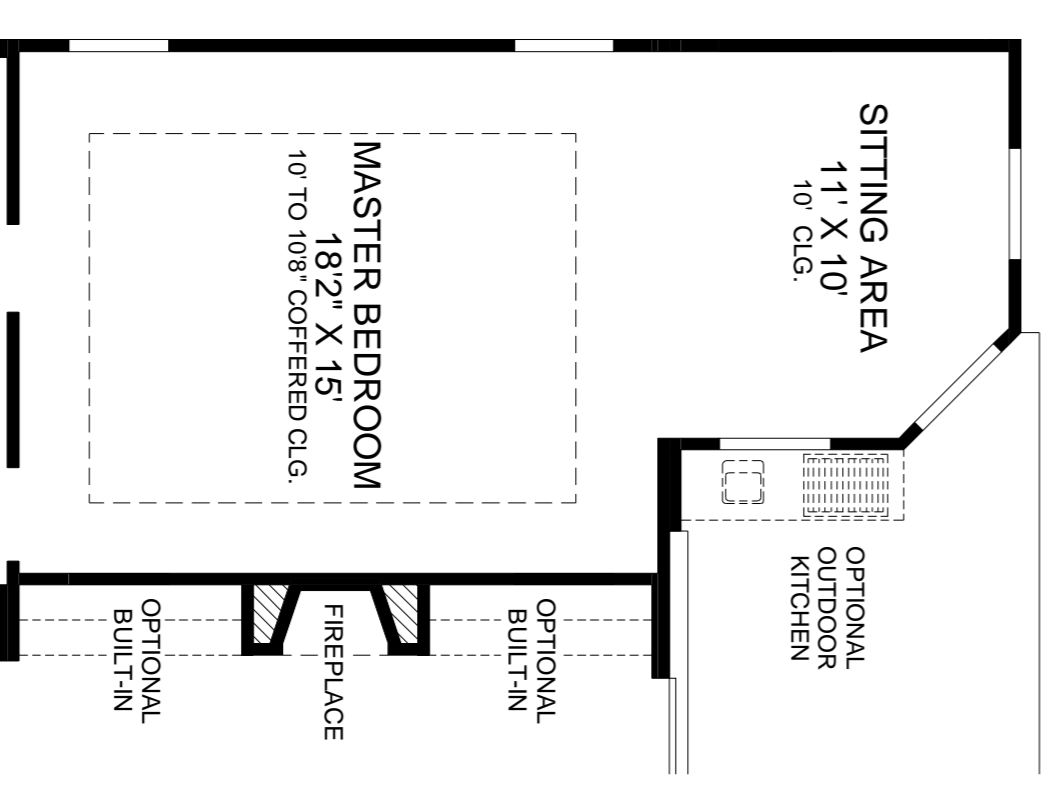

NOTE: THIS OPTION FEATURES AN ADDITIONAL 111 SQ. FT. OF AIR CONDITIONED LIVING AREA.

OPTIONAL EXPANDED MASTER BEDROOM

DRAFT



The floor plans and elevations of Toll Brothers homes are copyrighted. We have enforced and will continue to enforce our federal copyrights to protect the investment of our home buyers.

This insert was produced using recycled products.